

Cut in thirds vertically, and at 5" and 10" horizontally  
Color Front Side, Black & White, Back Side

# Easy LED™

The simple lighting solution

## 10 Solderless Connectors

Lighting as easy as 1, 2, 3:

- 1: Cut Easy LED to length
- 2: Slip on the solderless connectors
- 3: Stick to your model with integrated adhesive.

No more calculating resistors!



P/N: PGX152-10

[www.paragrafix.biz](http://www.paragrafix.biz)

Copyright © 2011 Paul H. Bodensiek. All Rights Reserved. ParaGrafix™, PGMS™, and Easy LED™ are trademarks of Paul H. Bodensiek dba ParaGrafix.

# Easy LED™

The simple lighting solution

## 10 Solderless Connectors

Lighting as easy as 1, 2, 3:

- 1: Cut Easy LED to length
- 2: Slip on the solderless connectors
- 3: Stick to your model with integrated adhesive.

No more calculating resistors!



P/N: PGX152-10

[www.paragrafix.biz](http://www.paragrafix.biz)

Copyright © 2011 Paul H. Bodensiek. All Rights Reserved. ParaGrafix™, PGMS™, and Easy LED™ are trademarks of Paul H. Bodensiek dba ParaGrafix.

# Easy LED™

The simple lighting solution

## 10 Solderless Connectors

Lighting as easy as 1, 2, 3:

- 1: Cut Easy LED to length
- 2: Slip on the solderless connectors
- 3: Stick to your model with integrated adhesive.

No more calculating resistors!



P/N: PGX152-10

[www.paragrafix.biz](http://www.paragrafix.biz)

Copyright © 2011 Paul H. Bodensiek. All Rights Reserved. ParaGrafix™, PGMS™, and Easy LED™ are trademarks of Paul H. Bodensiek dba ParaGrafix.

# Easy LED™

The simple lighting solution

## 10 Solderless Connectors

Lighting as easy as 1, 2, 3:

- 1: Cut Easy LED to length
- 2: Slip on the solderless connectors
- 3: Stick to your model with integrated adhesive.

No more calculating resistors!



P/N: PGX152-10

[www.paragrafix.biz](http://www.paragrafix.biz)

Copyright © 2011 Paul H. Bodensiek. All Rights Reserved. ParaGrafix™, PGMS™, and Easy LED™ are trademarks of Paul H. Bodensiek dba ParaGrafix.

# Easy LED™

The simple lighting solution

## 10 Solderless Connectors

Lighting as easy as 1, 2, 3:

- 1: Cut Easy LED to length
- 2: Slip on the solderless connectors
- 3: Stick to your model with integrated adhesive.

No more calculating resistors!



P/N: PGX152-10

[www.paragrafix.biz](http://www.paragrafix.biz)

Copyright © 2011 Paul H. Bodensiek. All Rights Reserved. ParaGrafix™, PGMS™, and Easy LED™ are trademarks of Paul H. Bodensiek dba ParaGrafix.

# Easy LED™

The simple lighting solution

## 10 Solderless Connectors

Lighting as easy as 1, 2, 3:

- 1: Cut Easy LED to length
- 2: Slip on the solderless connectors
- 3: Stick to your model with integrated adhesive.

No more calculating resistors!



P/N: PGX152-10

[www.paragrafix.biz](http://www.paragrafix.biz)

Copyright © 2011 Paul H. Bodensiek. All Rights Reserved. ParaGrafix™, PGMS™, and Easy LED™ are trademarks of Paul H. Bodensiek dba ParaGrafix.

# Black & White this Side

## Easy LED™ Solderless Connectors

Open Connector by  
Sliding Black Portion Out

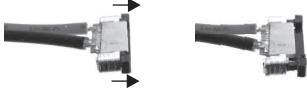

Slide Easy LED  
into Connector.

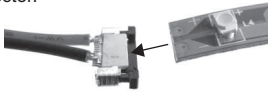

To make wiring easier, always connect the +  
side of the Easy LED to the red wire.

Note that the trough in the black portion of the  
connector must be facing up in relation to the  
LEDs to make a proper connection.



Trough

Insert Easy LED so that the connection points  
are completely in the connector.

Close Connector by  
Sliding Black Portion Back in Place

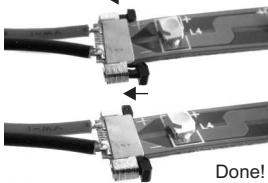

## Easy LED™ Solderless Connectors

Open Connector by  
Sliding Black Portion Out



Slide Easy LED  
into Connector.

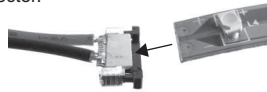

To make wiring easier, always connect the +  
side of the Easy LED to the red wire.

Note that the trough in the black portion of the  
connector must be facing up in relation to the  
LEDs to make a proper connection.



Trough

Insert Easy LED so that the connection points  
are completely in the connector.

Close Connector by  
Sliding Black Portion Back in Place

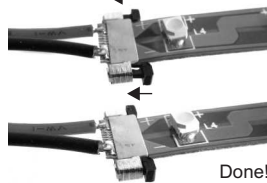

## Easy LED™ Solderless Connectors

Open Connector by  
Sliding Black Portion Out



Slide Easy LED  
into Connector.

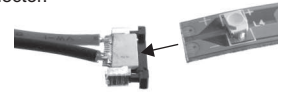

To make wiring easier, always connect the +  
side of the Easy LED to the red wire.

Note that the trough in the black portion of the  
connector must be facing up in relation to the  
LEDs to make a proper connection.



Trough

Insert Easy LED so that the connection points  
are completely in the connector.

Close Connector by  
Sliding Black Portion Back in Place

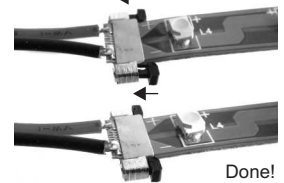

## Easy LED™ Solderless Connectors

Open Connector by  
Sliding Black Portion Out



Slide Easy LED  
into Connector.

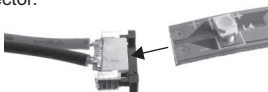

To make wiring easier, always connect the +  
side of the Easy LED to the red wire.

Note that the trough in the black portion of the  
connector must be facing up in relation to the  
LEDs to make a proper connection.



Trough

Insert Easy LED so that the connection points  
are completely in the connector.

Close Connector by  
Sliding Black Portion Back in Place

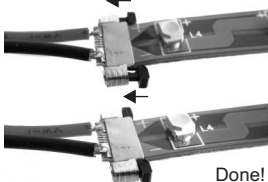

## Easy LED™ Solderless Connectors

Open Connector by  
Sliding Black Portion Out



Slide Easy LED  
into Connector.

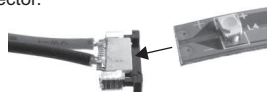

To make wiring easier, always connect the +  
side of the Easy LED to the red wire.

Note that the trough in the black portion of the  
connector must be facing up in relation to the  
LEDs to make a proper connection.



Trough

Insert Easy LED so that the connection points  
are completely in the connector.

Close Connector by  
Sliding Black Portion Back in Place

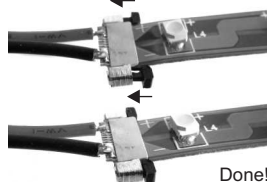

## Easy LED™ Solderless Connectors

Open Connector by  
Sliding Black Portion Out



Slide Easy LED  
into Connector.

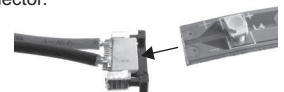

To make wiring easier, always connect the +  
side of the Easy LED to the red wire.

Note that the trough in the black portion of the  
connector must be facing up in relation to the  
LEDs to make a proper connection.



Trough

Insert Easy LED so that the connection points  
are completely in the connector.

Close Connector by  
Sliding Black Portion Back in Place

