

K'TINGA PHOTOETCH SET

**PARA
GRAFIX**TM
PGX218

ParaGrafix states that our use of the trademarked terms listed below in our product descriptions constitutes fair use and nominative use and is in no way to offer confusion that ParaGrafix and any of the following noted trademark holders are related companies, nor do we state that we are endorsed by these trademark holders. We are an AFTERMARKET company acting in GOOD FAITH in providing high quality products to loyal customers who have already purchased products related to these trademarks. ParaGrafix is actually providing these trademark holders a venue of free advertising and indirectly provide these trademark holders with more sales leads. Star Trek is a trademark of CBS Studios Inc. Polar Lights, AMT and Round 2 are registered trademarks of Round 2, LLC.

INTRODUCTION

Thank you for purchasing ParaGrafix's photoetch set for Polar Lights' K'Tinga-class Battle Cruiser. We have made every effort to ensure that these parts can be used successfully by a modeler of modest experience, but there may be items that require advanced modeling techniques. For a basic primer on the use of photoetch, please visit <http://www.paragrafix.biz/instructions.asp> for printed instructions and <http://www.paragrafix.biz/video-instructions-1.asp> for videos.

Materials

In addition to the photoetch, you will also need scissors or a knife* to remove individual pieces from the main fret, a file to remove material left from cutting, and super glue (aka CA or cyanoacrylate).

* We prefer a #17 Xacto chisel blade.

Key

Kit part (plastic): 1

Photoetched part: 1

TORPEDO TUBES

You have a couple of options when installing the torpedo tubes – you can use the clear kit parts or not, as desired. If not using the clear kit parts, etch part 2A should be used for the rear torpedo tube, since there is no inner lip to hold part 2A. Etch part 6 can be used either with or without the clear part for the forward tube.

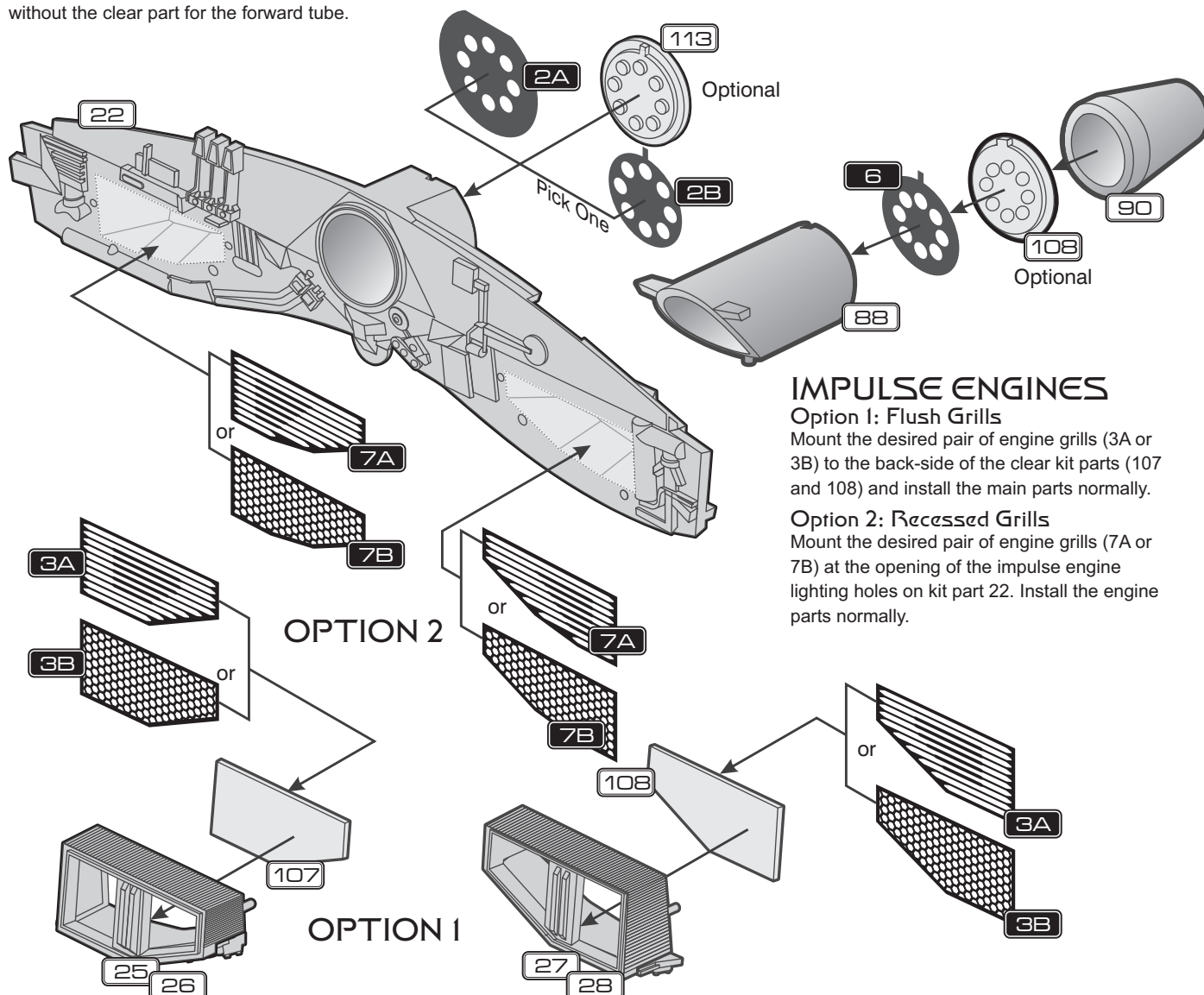

BRIDGE WINDOWS

File off the raised bridge windows from kit part 117, then wrap etch part 1 around the clear window piece with the Easy Bend ridges facing inward.

NOTE: Align the first end of the etch piece with one of the raised locator pins on the bottom of the kit part. This

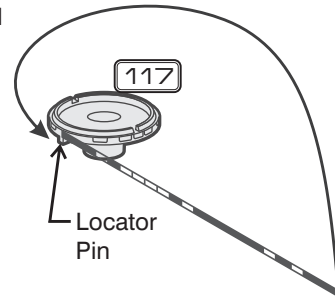

OFFICERS LOUNGE

LIGHTING OPTION: Cut out the window area between the window frames before filing off the frames themselves. After the etch part is in place, you can create the window "glass" using Micro Kristal Klear or Testors Clear Parts adhesive and Window Maker.

File off the kit window frames from part 46, then attach etch part 5 in place of them.

You may find it easier to shape part 5 if you anneal it first. You can learn about annealing by watching *Working with Photoetch Part 4: Annealing* located here: <http://www.paragrafix.biz/video-instructions-1.asp>

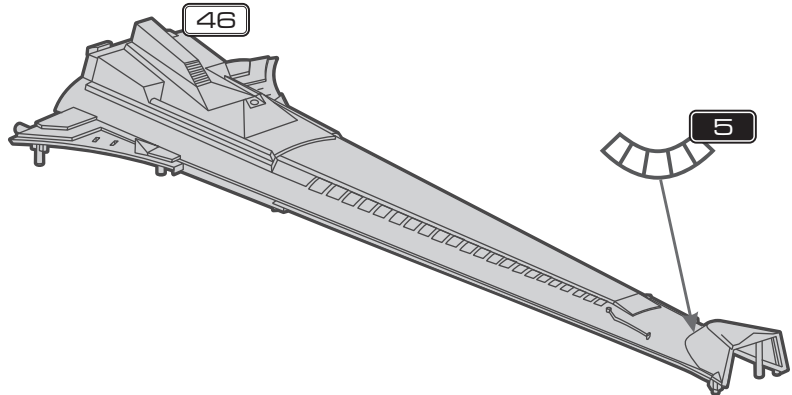

SECONDARY HULL WINDOWS

These parts help block light to give the windows sharp edges. Simply glue the photoetch parts between the hull (46) and the clear kit parts (101 and 102).

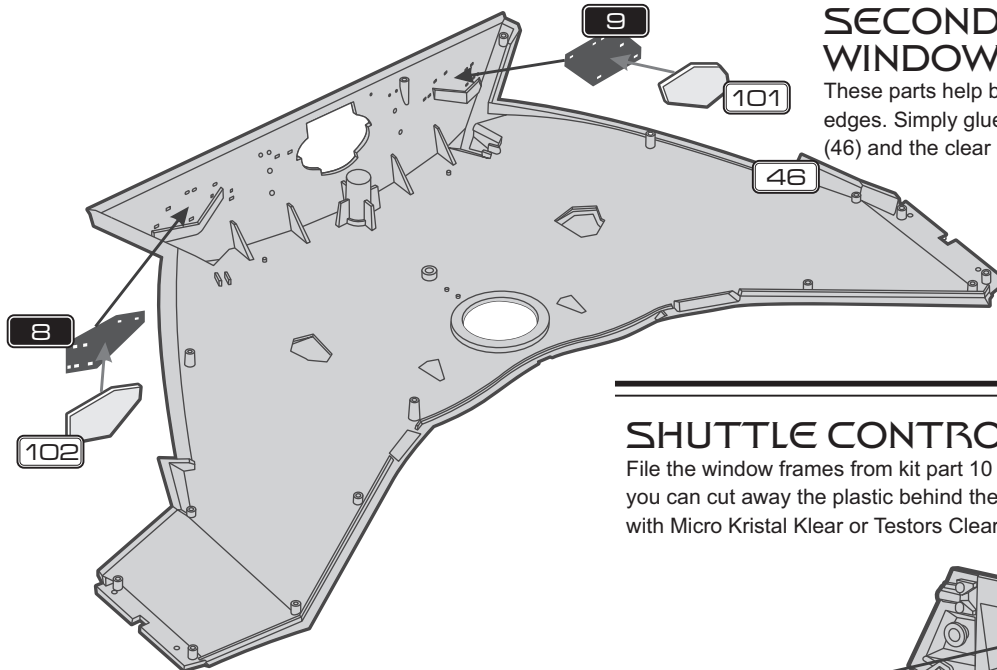

SHUTTLE CONTROL ROOM WINDOWS

File the window frames from kit part 10 and replace with etch part 4. If lighting, you can cut away the plastic behind the windows, then replicate the "glass" with Micro Kristal Klear or Testors Clear Parts Adhesive and Window Maker.

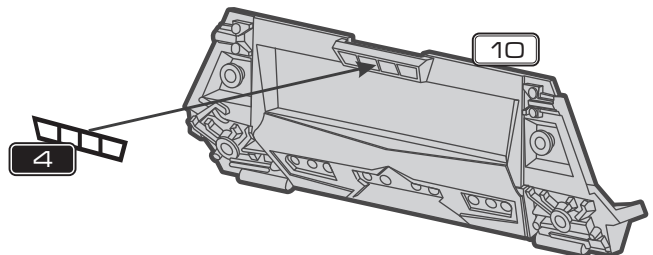

Attleboro MA 02703 USA
+1 508-431-9800
www.ParaGrafix.biz

Many thanks to Paul M. Newitt for his reference help and design ideas.

Original items copyright © 2018 Paul H. Bodensiek dba ParaGrafix. All Rights Reserved.
ParaGrafix is a trademark of Paul H. Bodensiek.