

# COLONIAL ONE WINDOW TEMPLATES



ParaGrafix states that our use of the trademarked terms listed below in our product descriptions constitutes fair use and nominative use and is in no way to offer confusion that ParaGrafix and any of the following noted trademark holders are related companies, nor do we state that we are endorsed by these trademark holders. We are an AFTERMARKET company acting in GOOD FAITH in providing high quality products to loyal customers who have already purchased products related to these trademarks. ParaGrafix is actually providing these trademark holders a venue of free advertising and indirectly provide these trademark holders with more sales leads. Battlestar Galactica® is a registered Trademark of Universal City Studios, LLLP LTD LIAB CO. All Rights Reserved.

## INTRODUCTION

Thank you for purchasing ParaGrafix's window templates for the *Battlestar Galactica* Colonial One by Moebius Models. This set is intended for modelers of moderate to advanced experience as some of the photoetched pieces will perform better when they have been annealed.

## Build Options

You have two options for using the photoetched parts – either as replacement “hull plating” or as templates to help aid in cutting the windows from the kit.

## Materials

In addition to the photoetch, you will also need scissors or a knife\* to remove individual pieces from the main fret, a file to remove material left from cutting, and super glue\*\* (aka CA or cyanoacrylate). You will also want Microscale's Micro Kristal Klear or Testors' Clear Parts Adhesive and Window Maker.

\* We prefer a #17 Xacto chisel blade.

\*\* For mounting the etched parts to the clear pieces, we suggest using Micro Metal Foil Adhesive from Microscale Industries.

## Installation Parts Order

In most cases you will want to prep the kit parts by removing excess plastic and/or cutting the windows from the kit prior to assembly. This will generally make cleanup and assembly easier. If you are using the “hull plating” method, then remove the plastic, assemble the kit, then attach the photoetched parts.

### Key

Kit part (plastic):

Photoetched part:

## Engines

If lighting, drill out the center of the engine mounts in 9, and at both ends of the nacelles (17/18, 19/20, 33/34) before adding the etch.

Mount the two open grills (14) to kit part 9, and place the turbines (13) into the engine bells (40/41).

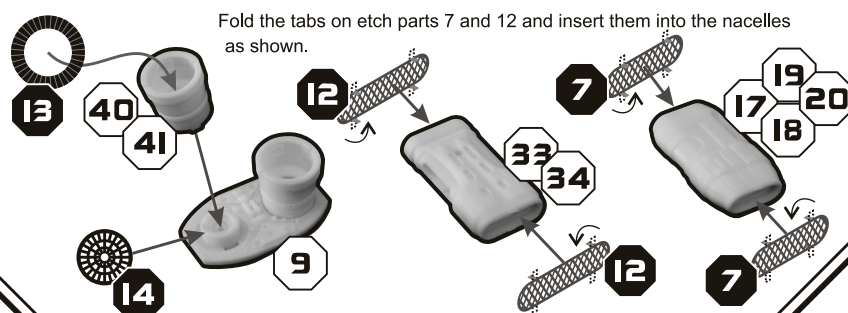

## Windows

Mount the templates in the positions shown.

**TIP:** If you will be using these templates as replacement “hull plating” then you will want to anneal the brass pieces before applying them. (Because 15 and 16 are so delicate, you will likely not need to anneal them.) Form the parts before permanently attaching them.

**TIP:** For best results, attach 15 and 16 using Micro Krystal Klear or Testors Clear Parts adhesive.

**NOTE:** Only one side is shown – apply the windows to both sides of the ship. All pieces except 5P and 5S can be used on either side of the ship. The “P” and “S” stand for Port (left) and Starboard (right), respectively.

Remove the kit plastic behind each window. If doing the “hull plating” method, you needn't be perfectly neat in your cutting.

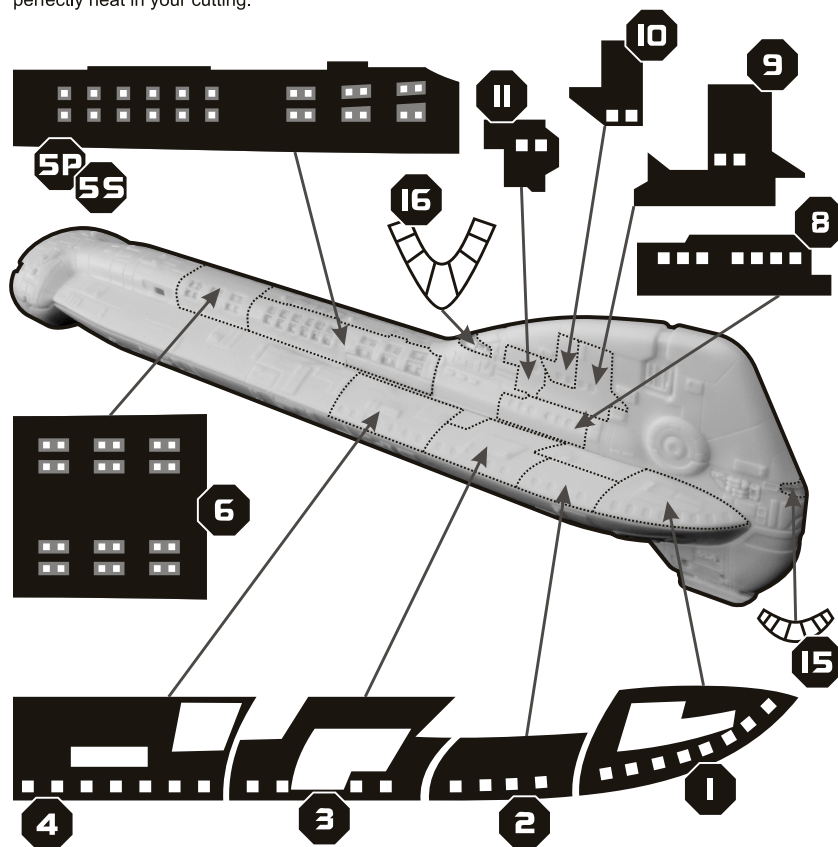

148 Rocklawn Ave.  
Attleboro MA 02703 USA  
+1 508-431-9800  
[www.ParaGrafix.biz](http://www.ParaGrafix.biz)

Thank you to Frank Winspur and Dave Metzner of Moebius Models for making such a great kit, and for their help and encouragement during the development of this add-on set.

Copyright © 2015 Paul H. Bodensiek. All rights reserved. ParaGrafix™ is a trademark of Paul H. Bodensiek. Moebius® is a registered Trademark of Moebius Models. All Rights Reserved.