

# RAPTOR PHOTOETCH SET



PGX207

ParaGrafix states that our use of the trademarked terms listed below in our product descriptions constitutes fair use and nominative use and is in no way to offer confusion that ParaGrafix and any of the following noted trademark holders are related companies, nor do we state that we are endorsed by these trademark holders. We are an AFTERMARKET company acting in GOOD FAITH in providing high quality products to loyal customers who have already purchased products related to these trademarks. ParaGrafix is actually providing these trademark holders a venue of free advertising and indirectly provide these trademark holders with more sales leads. Battlestar Galactica® is a registered Trademark of Universal City Studios, LLLP LTD LIAB CO. All Rights Reserved.

## INTRODUCTION

Thank you for purchasing ParaGrafix's photoetch set for the Moebius Models Raptor kit. Most portions of this set are quite straight forward to install. Some parts, however, require folding – if you are unfamiliar with this process, please see the videos on our site for instructions on folding photoetched parts.

### Materials

In addition to the photoetch, you will also need scissors or a knife\* to remove individual pieces from the main fret, a file to remove material left from cutting, and super glue (aka CA or cyanoacrylate). Additionally, to fold some pieces, you will need a pair of razor blades\*\* or a specialty tool such as PhotoFold from ParaGrafix.

\* We prefer a #17 Xacto chisel blade.

\*\* Extreme care must be taken when using razor blades. Risk of serious injury.

### Raised Detail

Where applicable, these instructions note an area where the raised kit detail must be removed. The symbol at left will show you where this needs to happen. This may be done in whatever way you are most comfortable: sanding, filing, chiseling. Note that in most cases the surface does not need to be perfectly smooth as the photoetched part will replace the "lost" kit detail.

### Lighting Options

Unless otherwise noted, you can prep areas for lighting by removing plastic from areas where there are through holes in the photoetch. You can then backlight the photoetch. For best results, we suggest using Micro Kristal Klear from Microscale Industries ([www.microscale.com](http://www.microscale.com)) to fill the through holes and adhere the backlight films in place. MKK can be tinted for or painted with transparent paint from behind for different colored lights.

**NOTE:** If lighting the displays, remove plastic to correspond with the openings in the photoetched parts..

### Key

- Kit part (plastic):
- Photoetched part:
- Backlight Film:
- Template:

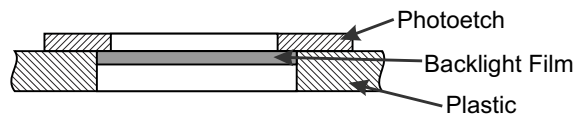

### Installation Parts Order

The installation steps are not in any particular order. You can complete them as you see fit to complement your kit construction order.

## ENGINES Repeat for Both Engines

Assemble both engines (kit parts 24/64 and 26/64) per the kit instructions, but leave off parts 77.

Fold etch parts 40 as shown, so the legs face forward.

**OPTIONAL:** Trim backlight film parts M and adhere to the back side of parts 40.

Install 40 in the engine openings - not that the small, rectangular detail should be located at the 7 o'clock position. (The legs should be vertical and horizontal, not at an angle.)

Attach etch parts 23 into the assembled engines so they rest and the base of the angled section with a gap between them and parts 40. The vanes should be positioned at 2, 4, 6, 8, 10, and 12 o'clock.

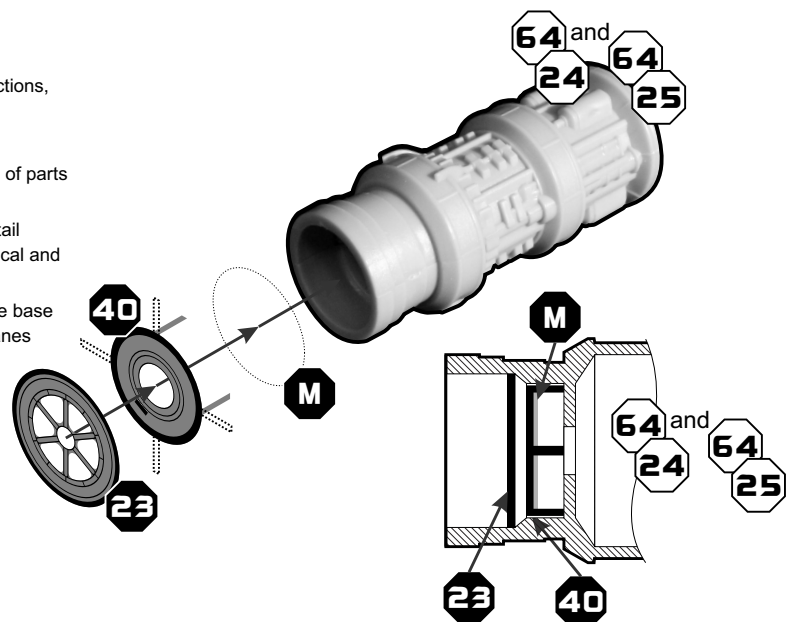

# WINGS

## Repeat two times

The kit's raised "walk here" bands on the wings are accurate to the CG "miniature". The full-sized set, however, uses different material (actual vented floor grates).

Remove the raised detail from kit parts 6 and 8 and replace with etch parts 2/3/4/5 (starboard side) and 19/20/21/34 (port / door side).

## Missing Hull Plating

### Repeat two times

The forward, angled portion of each wing is missing raised hull plating. Again, this is accurate to the CG model, but not the full-sized set. Included on the template sheet are the outlines of the new plating. Cut these shapes from 0.02" (0.5 mm) plastic sheet and attach in the positions shown.

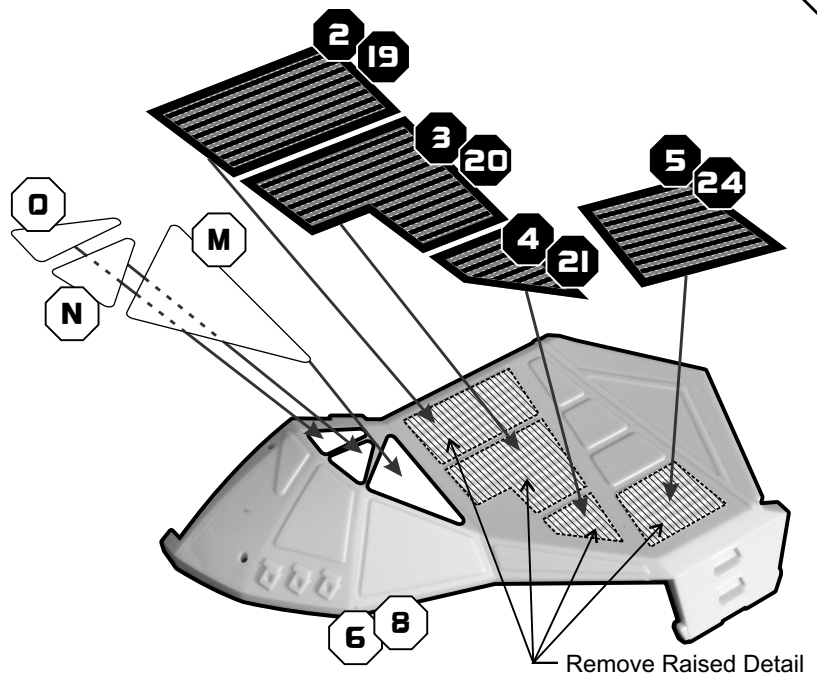

# BULKHEADS

## Über-detailing

Updating the bulkheads requires scratch building skills and may not be suitable for some builders.

Use the templates to mark the areas shown on the right, and cut out that material (including on the unseen far surfaces). Take into account the thickness of the plastic you will be using.

**NOTE:** The lower, horizontal portion of kit part 21 is even with control panel (part 59) installed in kit step 7. You may wish to temporarily assemble the interior to ensure that you get the height correct.

Cut out the console parts per the layouts on the template page and assemble them as shown in the diagram below.

**NOTE:** If lighting the displays, remove plastic to correspond with the openings in the photoetched parts.

Attach photoetched parts in the locations noted. You will likely find it easier to wait to fold and install etch part 44 (keyboard) until after you have assembled this section with the main console.

## NOT Über-detailing

If you do not do these modifications, simply attach parts 6, 11, 30, and 31 (and films G) to the stock kit parts.

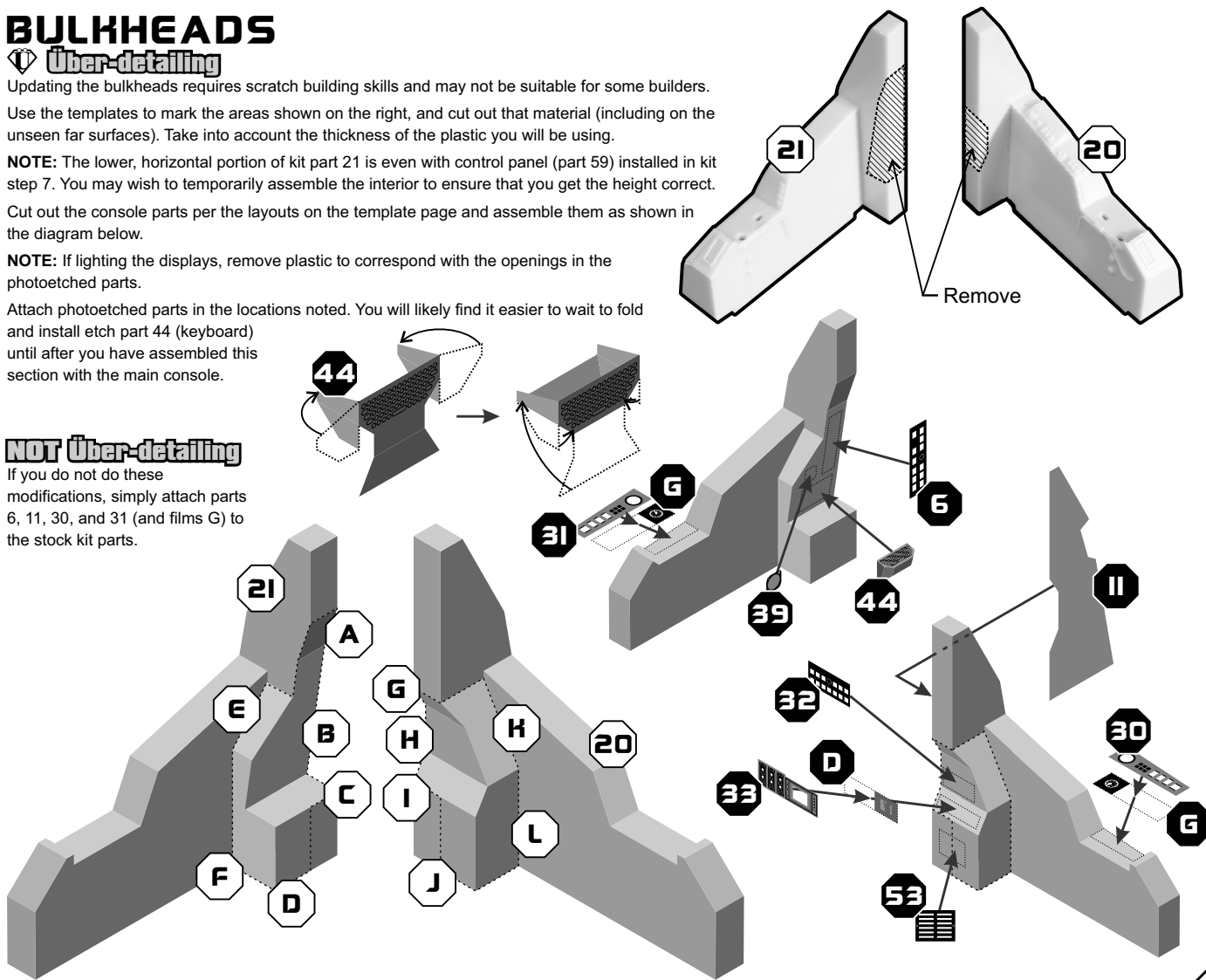

# COCKPIT INSTRUMENTS

**NOTE:** The kit supplied Main Screens (58) and Instrument Panel Cover (57) are accurate to some configurations of the Raptor. This set includes the single display version.

**Main Screen:** Fold etch part 16 as shown at right, then attach film F and etch parts 24 and 29.

**Instrument Panel Console:** Remove the raised detail from kit part 44 and attach etch part I.

Attach the main screen assembly to the instrument panel console.

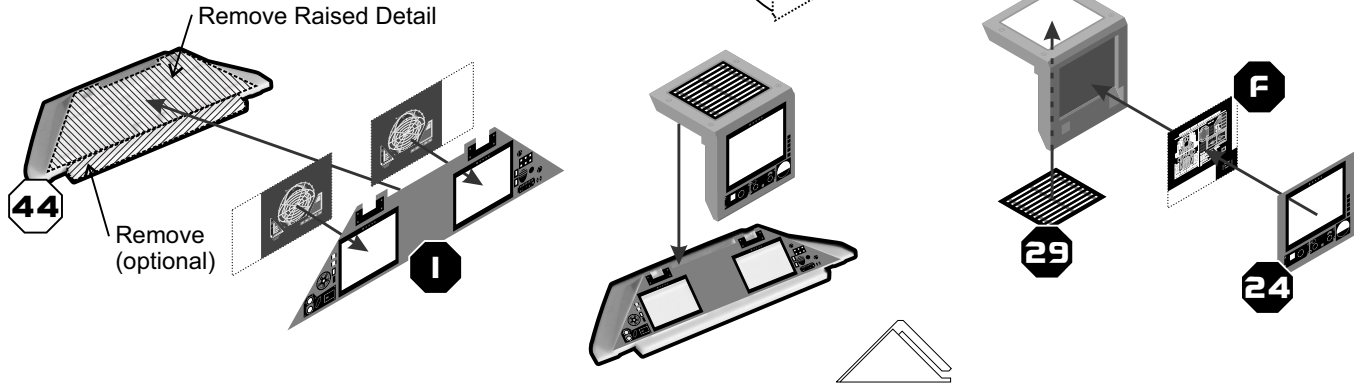

# MAIN CABIN

Remove raised control panel detailing where shown by the hatched boxes. Attach photoetch and backlight films in the locations shown.

If you uberdetail bulkheads, use parts 48 and I – otherwise use 37 and H.

Both desks (etch parts 18 and 35) are compromises based on footprint than on the full-sized set. Use the one that looks best to you. Note that the desk monitor is meant to be bent backwards so that the top touches the wall.

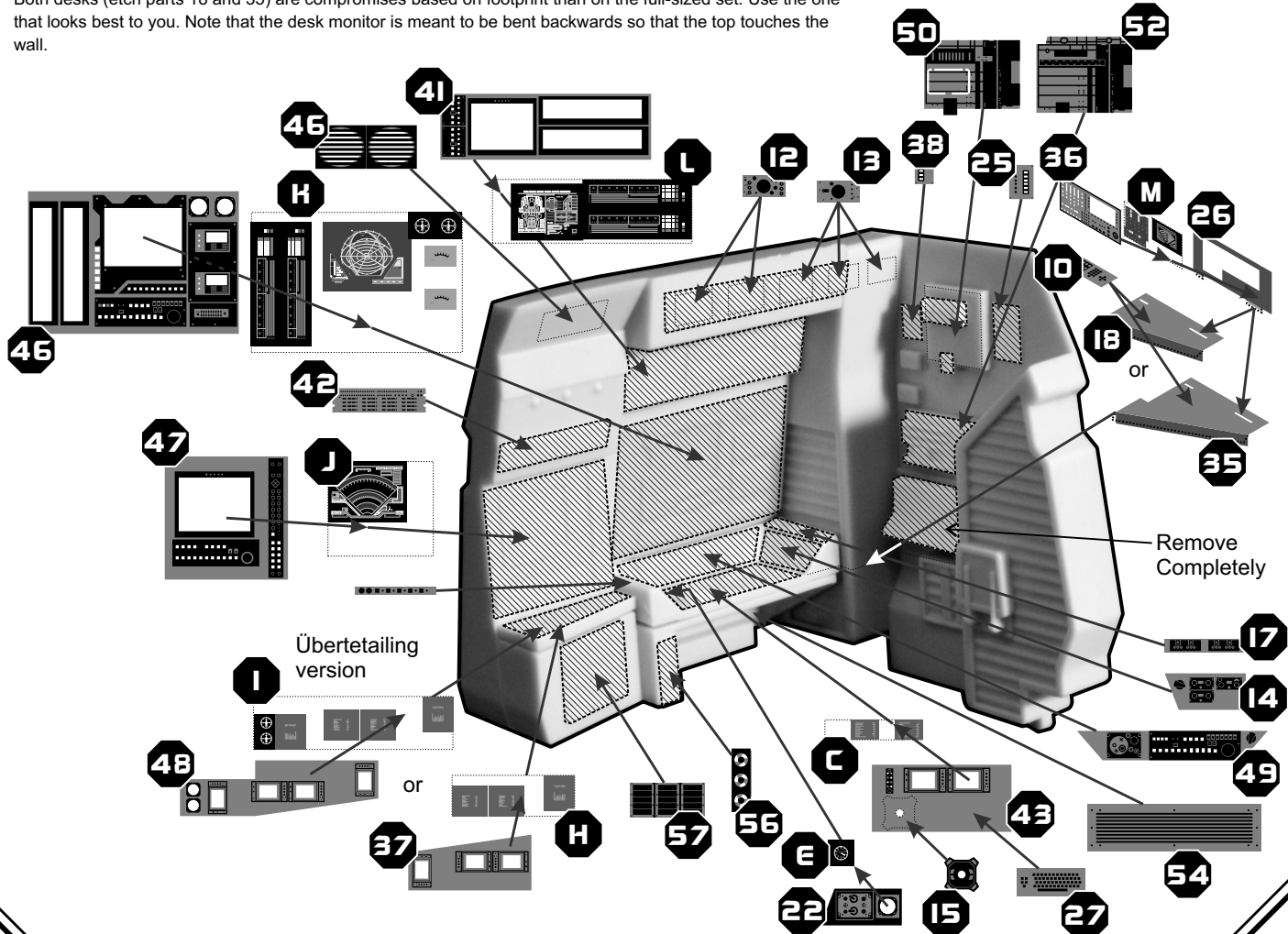

## Floor

**TIP:** Cut out the plastic behind the etch risers for a better lighting affect.

### Step

Fold etch part 10 as shown and attach to the floor (4) so that it's centered under the door.

**TIP:** Shim the step up slightly and add a light underneath to simulate the full-sized set.

### Riser Lighting - Lower

Attach etch part 9 to the lower section of the riser.

**TIP:** Cut out the plastic behind the etch part for a better lighting affect.

### Riser Lighting - Upper, non-Über-detailed

Bend etch part 8 and attach it to the upper riser.

### Riser Lighting - Upper, Über-detailed

Remove the kit plastic where shown. Use sheet plastic to create the now missing area of the step. Bend etch part 7 and attach it to the step riser.

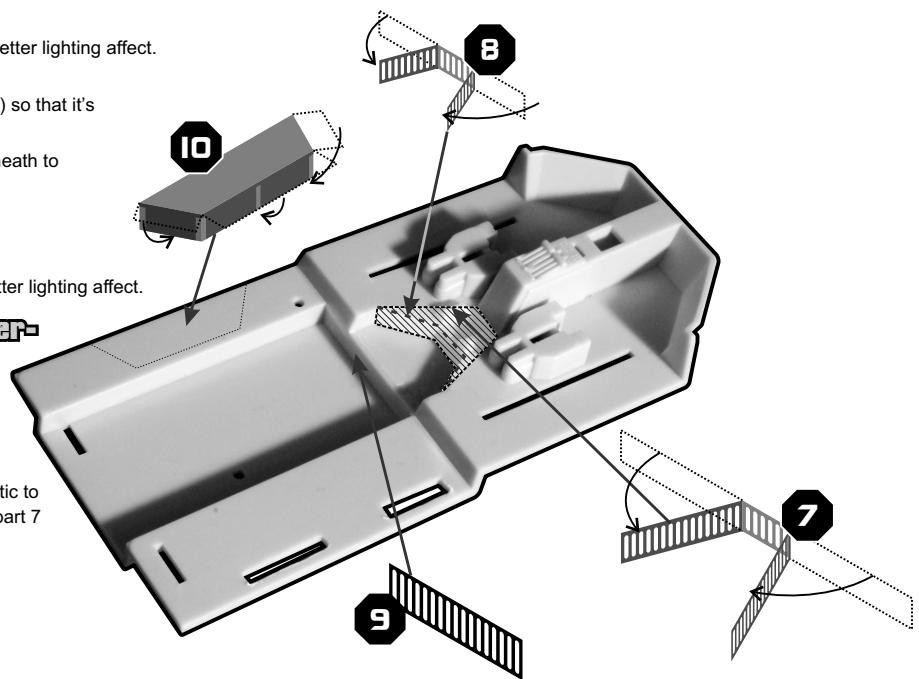

## DOOR HINGES

### Please Note

These hinges are not accurate to the full-sized Raptor's hinge, which is a piano-hinge type unit. They are included for modelers who wish to be able to open and close the door.

### Assembly

**TIP:** Do this assembly before assembling the fuselage (kit step 8). This will make it easier to fit the parts in place.

Fold the 2 door hinges (etch parts 51) as shown – fold the center of each hinge before folding the sides. Attach to the roof hinge (55) by folding the hinge plates as shown.

Glue the door hinges to the door, along the top, horizontal (when closed) portion.

Glue this assembly in place on the roof so that the hinges can move freely.

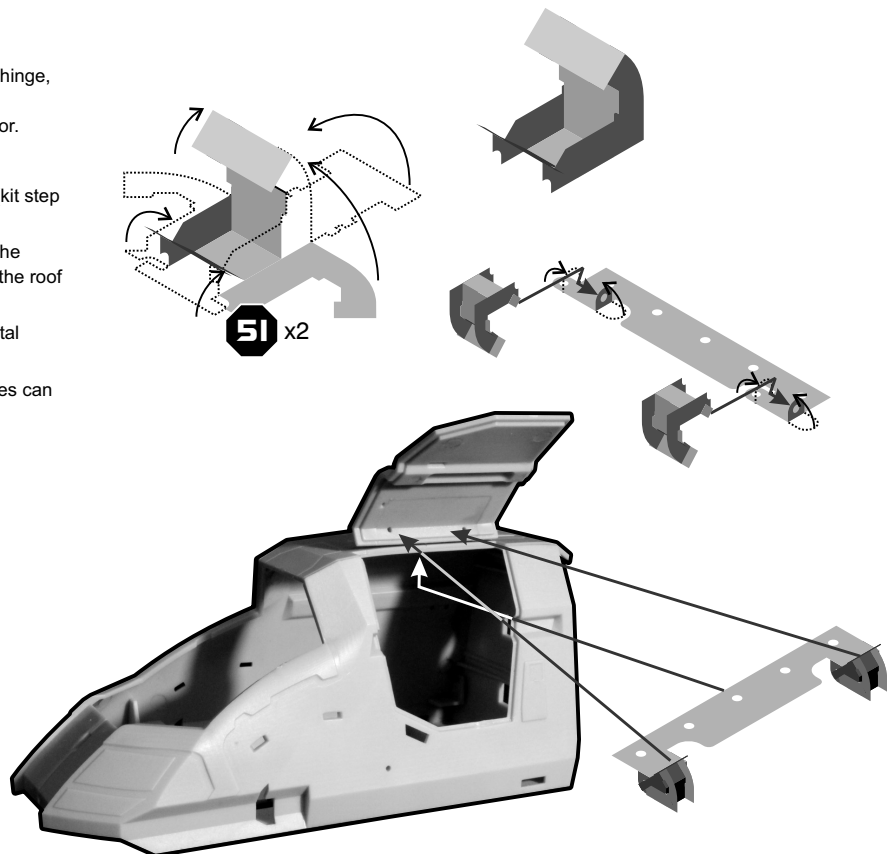

**PARA  
GRAFIX™**

104 County St. Suite 104  
Attleboro MA 02703 USA  
+1 508-431-9800  
www.ParaGrafix.biz

Thank you to Frank Winspur and Dave Metzner of Moebius Models for making such a great kit, and for their help and encouragement during the development of this add-on set.

