

Brian Johnson's Concept HAWK COCKPIT



Cockpit design copyright Brian Johnson Designs 2018. Used with permission.

ParaGrafix states that our use of the trademarked terms listed below in our product descriptions constitutes fair use and nominative use and is in no way to offer confusion that ParaGrafix and any of the following noted trademark holders are related companies, nor do we state that we are endorsed by these trademark holders. We are an AFTERMARKET company acting in GOOD FAITH in providing high quality products to loyal customers who have already purchased products related to these trademarks. ParaGrafix is actually providing these trademark holders a venue of free advertising and indirectly provide these trademark holders with more sales leads. Space: 1999 is a trademark of ITC Group Limited. 1975 and 2018. All Rights Reserved. MPC is a registered trademark of Round 2, LLC.

INTRODUCTION

Thank you for purchasing ParaGrafix's rendition of Brian Johnson's original concept for the Hawk cockpit. This design never made it past the design phase until now. Mr. Johnson was kind enough to license this design to us.

MATERIALS

In addition to the photoetch, you will also need photoetch scissors or a knife* to remove individual pieces from the main fret, a file to remove material left from cutting, and super glue (aka CA or cyanoacrylate). Additionally, to fold some pieces, you may need a pair of razor blades**, smooth-jawed pliers, or a specialty tool such as PhotoFold from ParaGrafix. Please note that no pilots are included with this photoetch set. The seats were designed using those supplied with Bandai's 1/72 scale Y-Wing fighter kit (0196694-3400).

* We prefer a #17 Xacto chisel blade.

** Extreme care must be taken when using razor blades. Risk of serious injury.

RAISED DETAIL

Where applicable, these instructions note an area where the raised kit detail must be removed. This may be done in whatever way you are most comfortable: sanding, filing, chiseling. Note that in most cases the surface does not need to be perfectly smooth as the photoetched part will replace the "lost" kit detail.

LIGHTING OPTIONS & CLEAR WINDOWS

The through holes in the control panels can be backlit. For best results, we suggest using Micro Kristal Klear from Microscale Industries (www.microscale.com) to fill the through holes and to cement clear parts in place. MKK can be tinted for different colored lights.

INSTALLATION PARTS ORDER

The installation steps are not in any particular order. You can complete them as you see fit to complement your kit construction order.

NEW

Kit part (plastic):

1

Photoetched part:

1

A: SEATS

REPEAT 2 TIMES

Fold seat structure, 1, as shown.

Attach cushions, 2 and 3, and side details, 21 and 22, in the positions indicated.

See an image of the completed seats on the next page under *Lower Cockpit Assembly*.

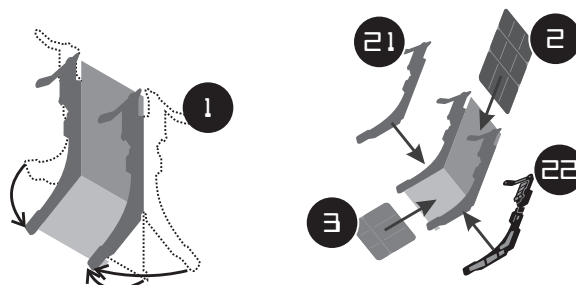

B: CONSOLES

SIDE CONSOLES

Fold the side consoles, 14 and 15, as shown. Fold down the small triangular tabs and "feet" on the throttles, 6, and mount into the slots on the consoles.

NOTE: The "feet" on the throttles only need to bend enough to let them be inserted neatly into the slots on the consoles.

CENTER CONSOLE

Fold the center console, 19, as shown, then attach joysticks, 5 in the slots.

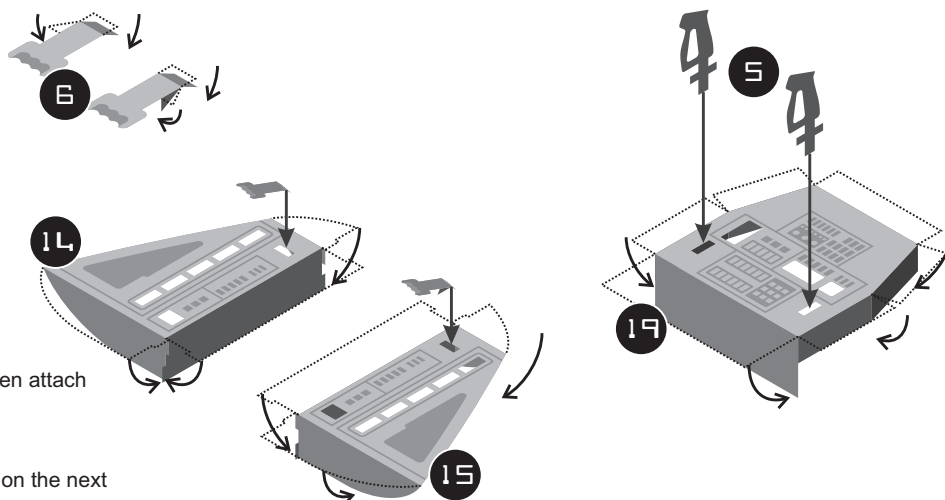

See an image of the completed consoles on the next page under *Lower Cockpit Assembly*.

C: MAIN STRUCTURE

SEAT PLATFORM

Fold down the two panels of the seat platform, 12, so that they are nice and square to the center portion.

CENTER SECTION

Fold down the three side panels of the center section, 17, so that they are square to the main platform.

ASSEMBLY

Slide the seat platform down over the slot in the center section, paying attention to the arrows so the thinner section of the platform faces the back. Cement in place.

Attach the center console (see previous page) so that the front lip is flush to both sides of the center section.

See an image of the completed structure on the next page under *Lower Cockpit Assembly*.

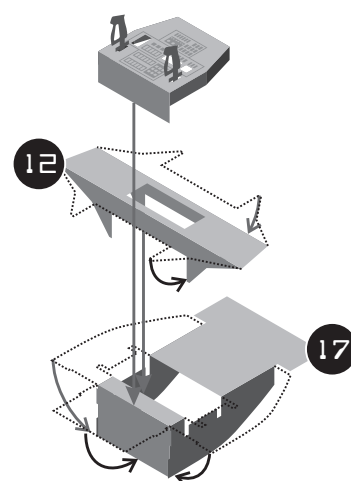

UPPER COCKPIT ASSEMBLY

MODIFY KIT WINDOWS

Using a file, remove material from the back side of the window insert, kit part 3, where the angles come together. Get the plastic as thin as possible so that the part to be removed simply falls away.

Take care not to file away the small detail molding at the base of the windows.

TIP: There is no need to file away all of windows. Just file away the two edges of the triangular windows meet the other flat portions.

REMOVE LOCATOR PINS

Remove the 2 locator pins in the cockpit area (where parts 8 and 9 are shown below). Make sure that the hull is smooth so the parts fit flush.

ASSEMBLE UPPER COCKPIT

NOTE: It is best to anneal parts 8, 9, 10, 11, and 13 before installation so that they can be formed to snugly fit the inside surface of the hull.

Mount kit part 3 to kit part 2.

Attach window frames 7, then form and attach parts 8, 9, 10, 11, and 13 in the positions shown. Mount the rear wall, 20A or 20B against the front edge of the ridge at the back of the cockpit. Note that 20B has 2 holes that allow #20 AWG Zip wire to pass through to allow lighting of the cockpit.

Attach the handholds, 25, to the top of the ridge just behind the windows. Make sure to leave enough room to install the clear "glass".

Allow the adhesive to fully cure so that it will not fog the "glass". While this is happening, use the template to cut clear window "glass" from the provided clear PETG plastic. Attach the windows using Micro Krystal Klear, Testors Clear Parts Cement and Window Maker, or your favorite.

Mount the forward control panel, 4, onto the clear parts also using one of the above mentioned adhesives.

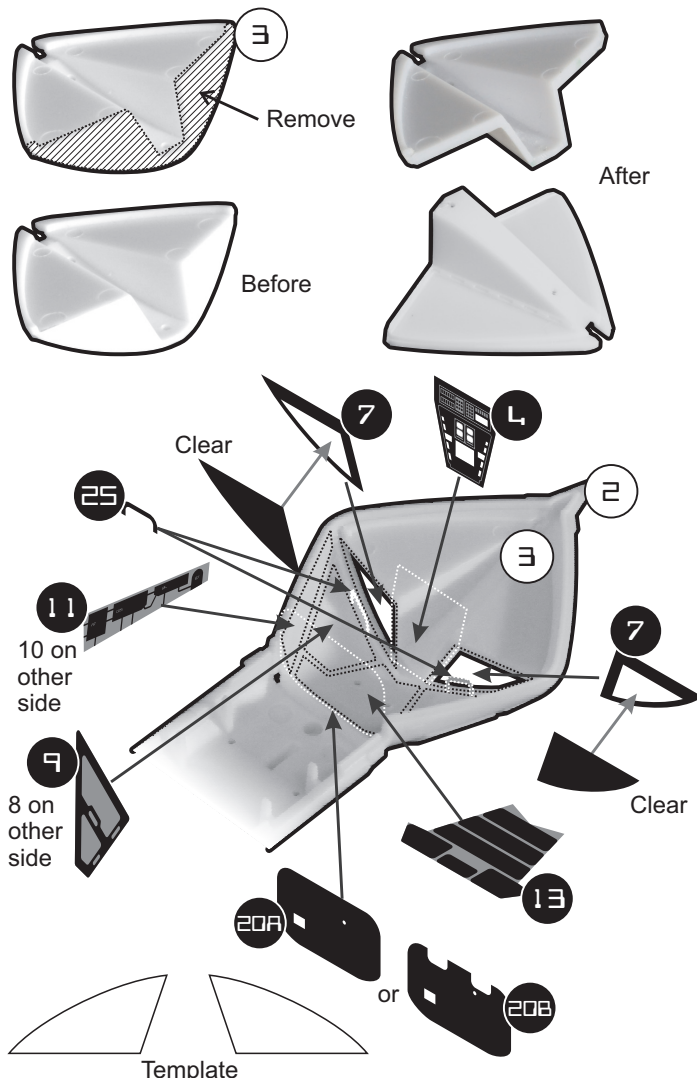

LOWER COCKPIT ASSEMBLY

NOTE: This assembly uses the parts constructed on the previous page.

Remove the two locator pins on the lower hull, part 1. You don't have to get them perfectly smooth as the will be covered by the side consoles assembled on the previous page.

Attach the main structure, assembled above, so that the rear "T" sits centered against the small ridge at the back of the cockpit area.

Mount the two control chairs to the forward "T" area, flush to the center console.

Attach the side consoles as shown.

PILOTS

Please note that no pilots are included with this photoetch set. The seats were designed using those supplied with Bandai's 1/72 scale Y-Wing fighter kit (0196694-3400).

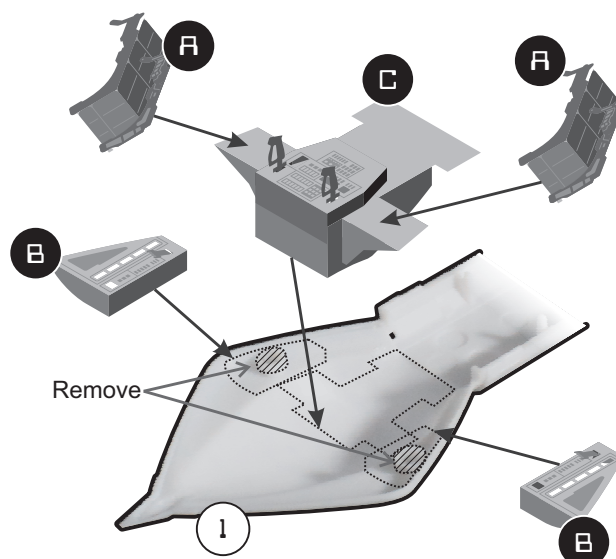

BONUS: EXTERIOR DRILLING GUIDES

These guides will help you get straight holes in the edges of some parts, where they couldn't be added because of molding restrictions.

TIP: Remove the raised rectangles on the front of wings 7 and 8 before proceeding.

Align the drilling guides with the parts as shown and tape in place. Then simply turn a 1/32" (0.032", 0.8mm) drill bit a few times in each hole to make the appropriate indentation. These holes do not have to be deep. Once drilling is complete, remove the tape and photoetched parts.

Put a drop of black paint in each hole when painting.

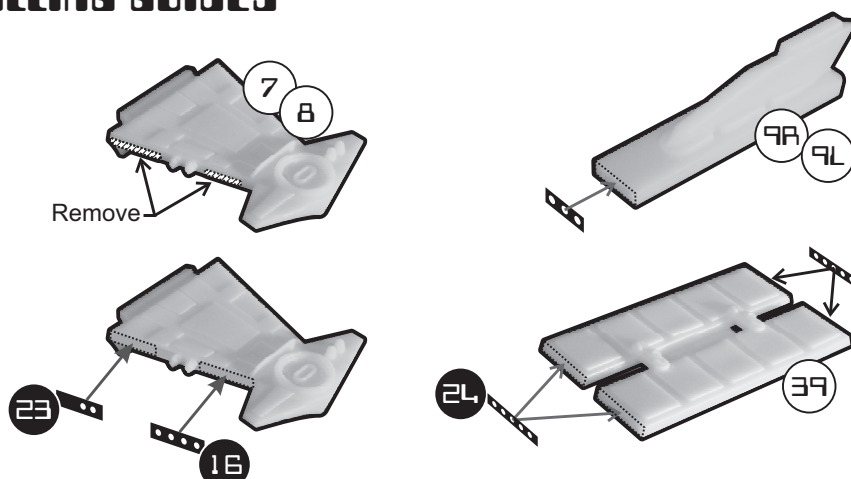

Attleboro MA 02703 USA
+1 508-431-9800
www.ParaGrafix.biz

Special thanks to Brian Johnson for providing his original sketches for the development of this photoetch set.

Thank you to Peter Greenwood for setting up the arrangement with Mr. Johnson.

Thank you to Round 2 Models for providing the test shot used during development.