

Cut to 9" tall and 7-1/4" wide, then fold to 3-5/8" wide x 4-1/2" tall with masthead out.



INTRODUCTION

Thank you for purchasing this replacement dome set for the venerable "Land of the Giants" *Spindrift* kit. With only a single modification, the included cast resin parts update the top of the Spindrift with an accurate teardrop shaped dome and 3dimensional honeycomb pattern.

In addition to the usual glues, adhesives, and paints required for the rest of the kit, we suggest the following additions:

Clear Parts Adhesive: Microscales' Micro Krystal Klear or Testors' Clear Parts Adhesive and Window Maker. Use one of these to attach the dome - since they dry clear they will not mar the look of the dome. (They're also great for use in installing the kit's windows as they won't craze clear polystyrene parts.)

Super Glue or Epoxy: The resin dome support **can not** be attached with standard polystyrene modeling glues. Use super glue (AKA CA / cyanoacrylate) or epoxy cement instead.

Future Floor Polish: Although the name has been changed many times, this is the go-to coating for ensuring a perfectly smooth, shiny surface on clear parts. In the USA it's current name is "Pledge Floor Gloss", though this is subject to change without notice.

If you are unfamiliar with using Future, there are many tutorials online. One straight-forward tutorial can be found on the Hobby Link International YouTube feed at:

<https://www.youtube.com/watch?v=Ooir8nyZqM4>

BONUS PARTS!

NOTE: These parts are fragile! Even though an extra of each is included with this set, they should be the last parts you install on your kit.

Simply install the antenna and probe in place of kit parts 32 and 33, respectively.

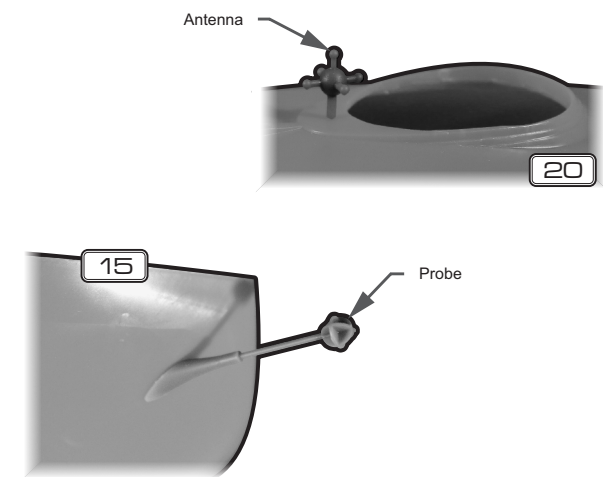

Special thanks to Doll & Hobby GA's Steve Iverson and Bob Plant for permission to use their box artwork for this product.

DOMESTALLATION

Modify Kit

TIP: Use the marked centerlines to align the template. Use the antenna mounting hole and vertical fin slot as guides to draw a light centerline on your kit.

Use the template (below) to mark the upper surface of the fuselage (kit part 20). Employing your preferred method remove the kit material.

NOTE: Do not smooth out the underside at the front of the fuselage. This lip sets the height of the front of the dome support insert.

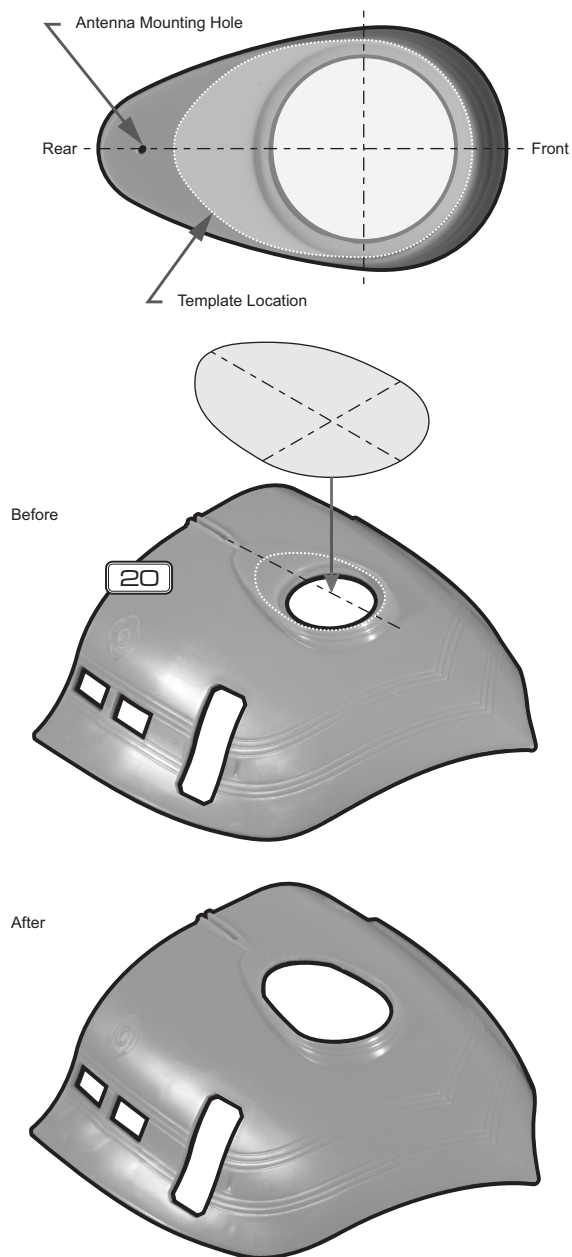

DOMESTALLATION

Install Dome

Insert the dome support into the enlarged hole so that the top is flush with the fuselage. Putty and fill the resulting seam making sure not to fill the channel around the support. (The front curve of the fuselage is part of this channel.)

TIP: Note that the bottom of the dome support includes raised centerline indicators to help you align it properly.

Attach the clear dome so that the thin ridge fits within the groove on the dome support.

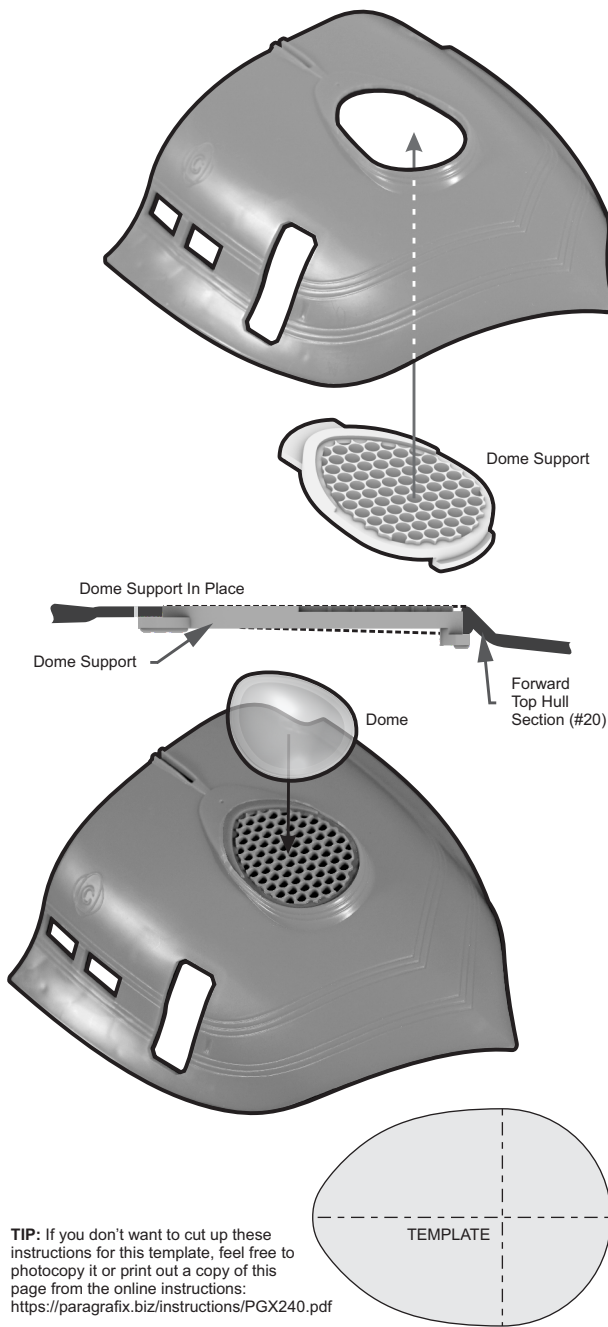

TIP: If you don't want to cut up these instructions for this template, feel free to photocopy it or print out a copy of this page from the online instructions:
<https://paragrafix.biz/instructions/PGX240.pdf>