

Easy LED™ Solderless Clamshell Connectors

1. Open the clamshell connector.

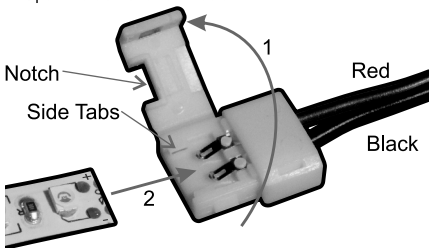

2. Slide Easy LED strip into the connector, making sure it goes under the side tabs and that the metal prongs touch the strip's connection points. If the prongs don't touch the connection points, the strip will not light.*

* When using Easy LED-HD strips, you may have to adjust the size of the notch in the connector (using a file or hobby knife) to allow the strip to fully engage.

For easier connecting in your model, make sure that the side marked "+" is on the RED side of the connector.

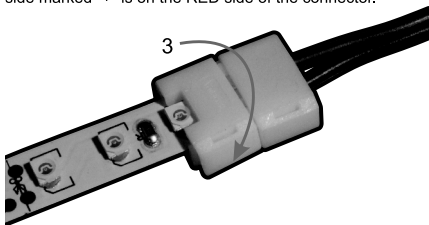

3. Close the clamshell connector.

DONE!

Copyright © 2016 Paul H. Bodensiek. All rights reserved. ParaGrafix™ and Easy LED™ are trademarks of Paul H. Bodensiek.